



Model Number:  
**F-BPSX-7075**

RF Components

# S-Band Bandpass Filter

2324.25-2328.25 MHz

- Dielectric Filter

Available with RF connector options:

- 50 Ω SMA

Physical Dimensions (± 0.3mm)

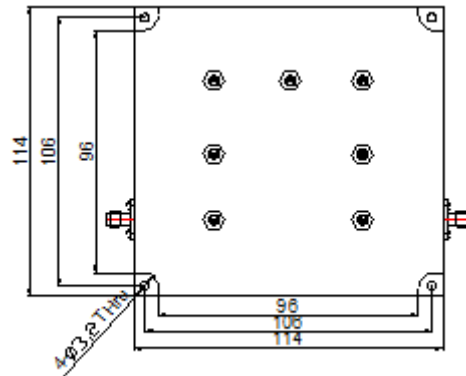
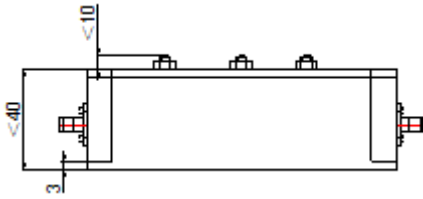

# Filter

RF Parameters	
F-BPSX-7075	S5S5
Frequency Range	2324.25-2328.25 MHz
RF Connectors	50Ω SMA Female
Insertion Loss (dB)	≤1.2dB
Return Loss (dB) Min	14
Rejection	≥45 dB @ 2320 & 2332.5 MHz
Max RF Power	40W

Environmental	
Operating Temperature	-40°C to +65°C
Storage Temperature	-55°C to +85°C
Location	For Indoor use

## Broadcast



## Marine Oil & Gas



## SNG & VSAT



## Satellite Teleport

